

ZENworks 11 SP3 Asset Inventory - Detecting Windows 8 Metro Applications

February 2014

Novell®

ZENworks 11 SP3 supports Windows 8 as a new platform. For each Windows 8 managed device, the device's inventory report includes a listing of the device's Metro Applications in addition to the standard list of software products.

1 Prerequisites

- ◆ Ensure that you have the View Detailed Inventory right.
- ◆ Ensure that you have a Windows 8 device with Metro Applications installed.

2 Workflow Diagram

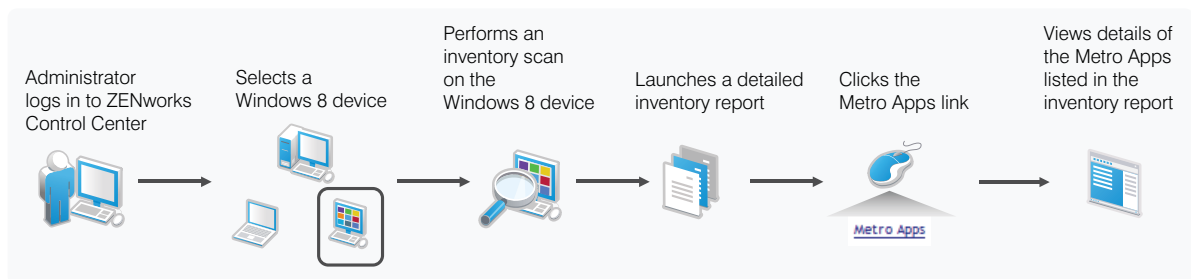

3 Procedure

To view the list of Metro Applications for a Windows 8 managed device:

- 1** Perform an inventory scan on a Windows 8 device that has Metro Applications installed.
- 2** After the inventory scan is finished, open the device's detailed inventory report in ZENworks Control Center:
 - 2a** Click *Devices > Workstations*.
 - 2b** Select the Windows 8 device for which the inventory scan is completed.
 - 2c** Click the *Inventory* tab.
 - 2d** Click *Detailed Hardware or Software Inventory*.
 - 2e** Click the *Metro Apps* link in the inventory report.

The details of the Metro Applications that are installed on the Windows 8 device are displayed.

4 Legal Notices

Novell, Inc. makes no representations or warranties with respect to the contents or use of this documentation, and specifically disclaims any express or implied warranties of merchantability or fitness for any particular purpose. Further, Novell, Inc. reserves the right to revise this publication and to make changes to its content, at any time, without obligation to notify any person or entity of such revisions or changes.

Further, Novell, Inc. makes no representations or warranties with respect to any software, and specifically disclaims any express or implied warranties of merchantability or fitness for any particular purpose. Further, Novell, Inc. reserves the right to make changes to any and all parts of Novell software, at any time, without any obligation to notify any person or entity of such changes.

Any products or technical information provided under this Agreement may be subject to U.S. export controls and the trade laws of other countries. You agree to comply with all export control regulations and to obtain any required licenses or classification to export, re-export, or import deliverables. You agree not to export or re-export to entities on the current U.S. export exclusion lists or to any embargoed or terrorist countries as specified in the U.S. export laws. You agree to not use deliverables for prohibited nuclear, missile, or chemical biological weaponry end uses. Please refer to the [Novell International Trade Services Web page \(http://www.novell.com/info/exports/\)](http://www.novell.com/info/exports/) for more information on exporting Novell software. Novell assumes no responsibility for your failure to obtain any necessary export approvals.

Copyright © 2014 Novell, Inc. All rights reserved. No part of this publication may be reproduced, photocopied, stored on a retrieval system, or transmitted without the express written consent of the publisher.

Novell, Inc.
1800 South Novell Place
Provo, UT 84606
U.S.A.
www.novell.com

Online Documentation: To access the latest online documentation for this and other Novell products, see the [Novell Documentation Web page \(http://www.novell.com/documentation\)](http://www.novell.com/documentation).

Novell Trademarks

For Novell trademarks, see [the Novell Trademark and Service Mark list \(http://www.novell.com/company/legal/trademarks/tmlist.html\)](http://www.novell.com/company/legal/trademarks/tmlist.html).

Third-Party Materials

All third-party trademarks are the property of their respective owners.